

MAKE OUR SURAT CITY SMART (ROUND-2) Contest For Visual Improvement-Park

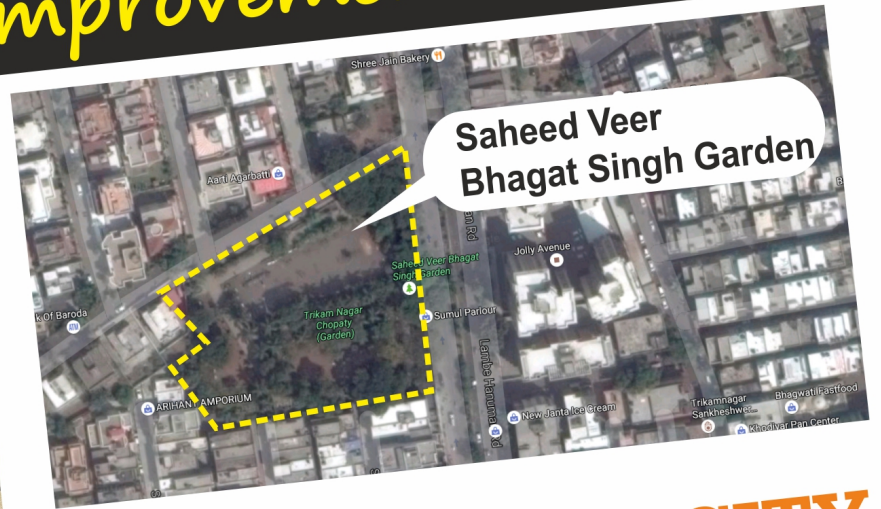

SURAT SMART CITY

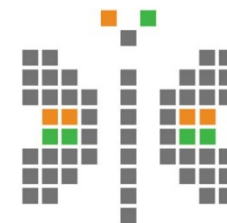

Smart City

MISSION TRANSFORM-NATION

WINNER : 1
VISHAL PAREKH

Name : Vishal V Parekh

**Resi.: 117, Kotyark Nagar, opp.
Navyug college, Rander road,
Surat.**

Age: 35

Gender: Male

Firm: AR.VISHAL PAREKH

**Address: 409, Kinaro apartment,
Nanpura, Surat.**

**Contact: +91 9879317886
+91 9624821190**

EMAIL ID:

Ar.vishalparekh@gmail.com

vishalvparekh@yahoo.com



CONTEST- PARK DESIGN



PC : VISHAL PAREKH

3. Stone bedding in play area which is not advisable for children because when they fall they can get hurt by those stone badly.

4. Shrubs and bushes are not lined up and grown properly and their no flower plant which can make garden look attractive.



PC : VISHAL PAREKH

2. Old drinking water facility system. Cleaning is not done properly and not properly constructed because of that hygiene is not maintain.



3

1. Cement concrete benches are provided which are either cracked up or corners are broken down. Benches are not in symmetric design like some are of cement concrete or some are of mosaic tile , so theirs no harmony



1



PC : VISHAL PAREKH

2

5. Undulating landscape area with muddy floor. Also have broken seating around trees which creates obstruction in space.



5

PC : VISHAL PAREKH

PROBLEM STATEMENT-01

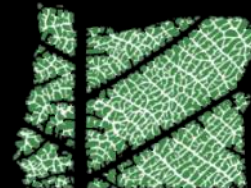

Legend featuring retrofitting

- 1. Entrance gate do not reflect the standard of existence
- 2. A structure in dilapidated condition
- 3. Retrofitting required for gazebo
- 4. A disturbing situation of light pole
- 5. Undulating surfaces
- 6. Broken seating around trees
- 7. Stone bedding in play area
- 8. Unhygienic drinking water place
- 9. Unplanned plantation
- 10. Broken and variety of benches
- 11. Unplanned spaces



Existing Plan



PC : VISHAL PAREKH



PC : VISHAL PAREKH

6. All over garden look flat, its not looking refreshing which all people look forward for a garden. In some areas shrubs and bushes are not grown properly and plant protection wall is not provided in some areas.

7. Though theirs an ample of light provided but they are not placed properly because of which light is not reaching beyond trees and corner area.

PROBLEM STATEMENT-02

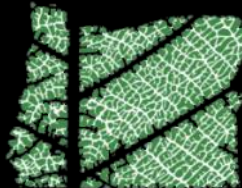

LIGHTING

4.5M HIGH SOLAR STREET LIGHT

FLOOD LIGHT

SOLAR PENALS TO BE USED FOR ENERGY CONSERVATION

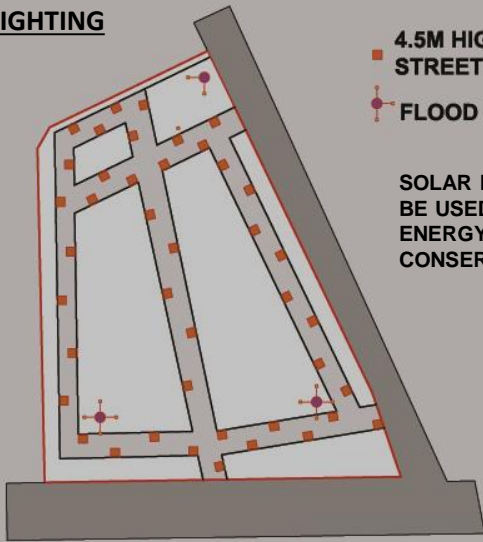

ACTIVITY ZONING

- GARDEN GYM
- CHILDREN PLAY
- LANDSCAPE GRDEN
- ZEN GARDEN

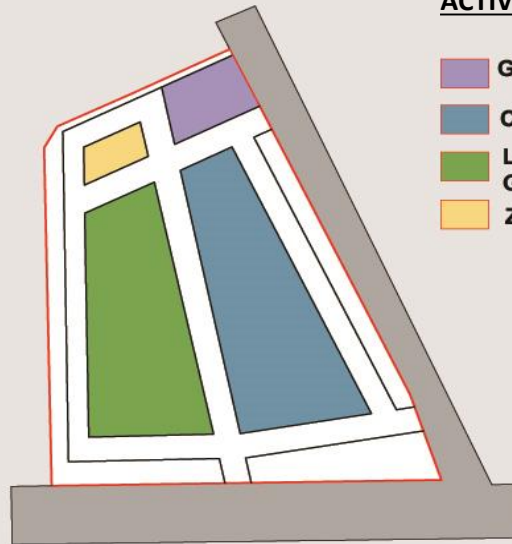

PLANTATION

- LARGE AND UNIQUE TREES TO BE RETAINED
- SMALL AND OBSTRUCTED TREES TO BE RELOCATED OR REPLNATED
- LAWN AND SHRUBS AREA



RAIN WATER MANAGEMENT

RECHARGING BOREWELL

USE OF RAIN WATER FROM SURFACED AREA APPROX 800 SQM.

USE OF PERMIABLE PAVER BLOCK ON PATHWAYS

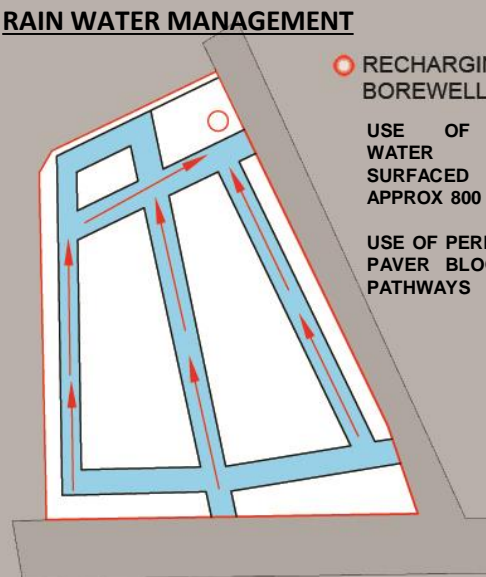

- A KEY ASPECT OF SALIENT FEATURE IS TO DESIGN A PARK WITH INDEGINOUS ELEMENTS KEEPING IN MIND THE CONCEPT ENERGY CONVERSATION.
- THE CONCEPTUAL THOUGH OF ENERGY CONSRVATION IS INCORPORATED IN TERMS OF LIGHTING USING SOLAR PENALS, MAKING GARDEN FEATURES USING RECYCLED MATERIALS AND WATER CONSEVATION THROUGH RAIN WATER HARVESTING.
- THE DESIGN RETAINS THE LARGE AND UNIQUE TREES. SMALL PLANTS WHICH ARE OBSTRUCTING THE SPACE ARE RELOCATING OR REPALCED WITH ALL WATHER NATIVE PLANTS TO MINIMIZE IFFIGATION REQUIREMENT AND PROLONGG TREE LIFE.
- ZONING HAS BEEN DEVELOPED THROUGH KEY PLANS SHOWING DEFFERENT ACTIVITIS, MATERIALS AND CONCEPT OF ENERGY SAVING.

SALIENT FEATURES OF PROPOSED SOLUTION (SCHEMETIC DIAGRAM) - 01

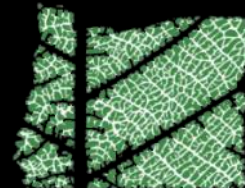

LEGEND

1. ENTRANCE GATE
2. PATHWAYS
3. SIGN BOARD
4. GAZEBO
5. BENCHES
6. PLAY AREA
7. DRINKING WATER FOUNTAIN
8. RAIN WATER HARVESTING
9. ZEN AREA
10. PLANTATION



1. Entrance is redesign in such a way that it attract people.
2. Pathways have sufficient amount of light poles at a particular height , so that light can reach without disruption of trees.
3. Garden will have newly design sign board for indication at proper area .
4. Gazebo has solar panels on it .
5. Benches provided are homogeneous in design and are rearranged in a proper way.
6. Change of flooring in children play area from pebbles to thin silt . Also making the skating ring in the inner periphery of children play area.
7. Drinking water fountain area is attractively design with easy excess to all age type.
8. Rain water harvesting slope has been redesign and modify to smoothness.
9. Zen area is provided for people to enjoy new landscape.
10. Growing natural flowers as well as pleasant plantation in designing manner.

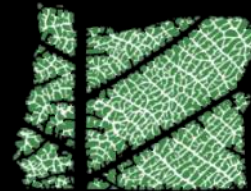



PROPOSED ENTRANCE



EXISTING ENTRANCE

A park in a city is a place of serenity and refreshment for a hectic life. Being a centre in a city it should reflect its identity through nature. The entrance welcomes with a metal mural of 'Shahid Bhagat Singh' in a silhouette of a tree. Roughness of the material will enhance the beauty of inherent nature.

GRAPHICAL PRESENTATION-01

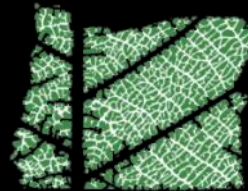



PROPOSED PATHWAY



EXISTING PATHWAY

When you enter in a park you are covered with an avenue of pergolas. A shadow of pergolas & surrounding trees makes nature more dramatic. A pathway is made of permeable concrete block to minimize loss of running rain water. There is a signboard on a corner which will guide you where & what to enjoy.

GRAPHICAL PRESENTATION -02

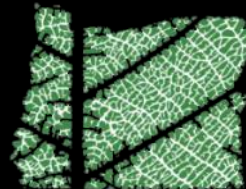



PROPOSED CENTRAL AREA



EXISTING CENTRAL AREA

Now you encounter in a central space or a junction. The frames made of local stones act as a pause. You are infatuated with a beauty of vertical garden in a stone frame.

GRAPHICAL PRESENTATION -03

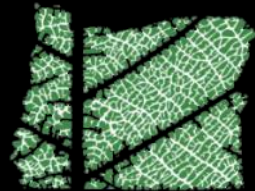



PROPOSED GAZEBO



The existing gazebo is a metal structure covered with roofing sheet. We proposed to make it more sustainable with solar panels installation on roof. These panels may help to run garden lamps at night & save fuel cost.

GRAPHICAL PRESENTATION -04

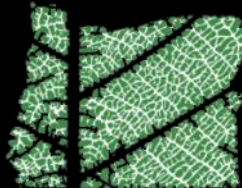

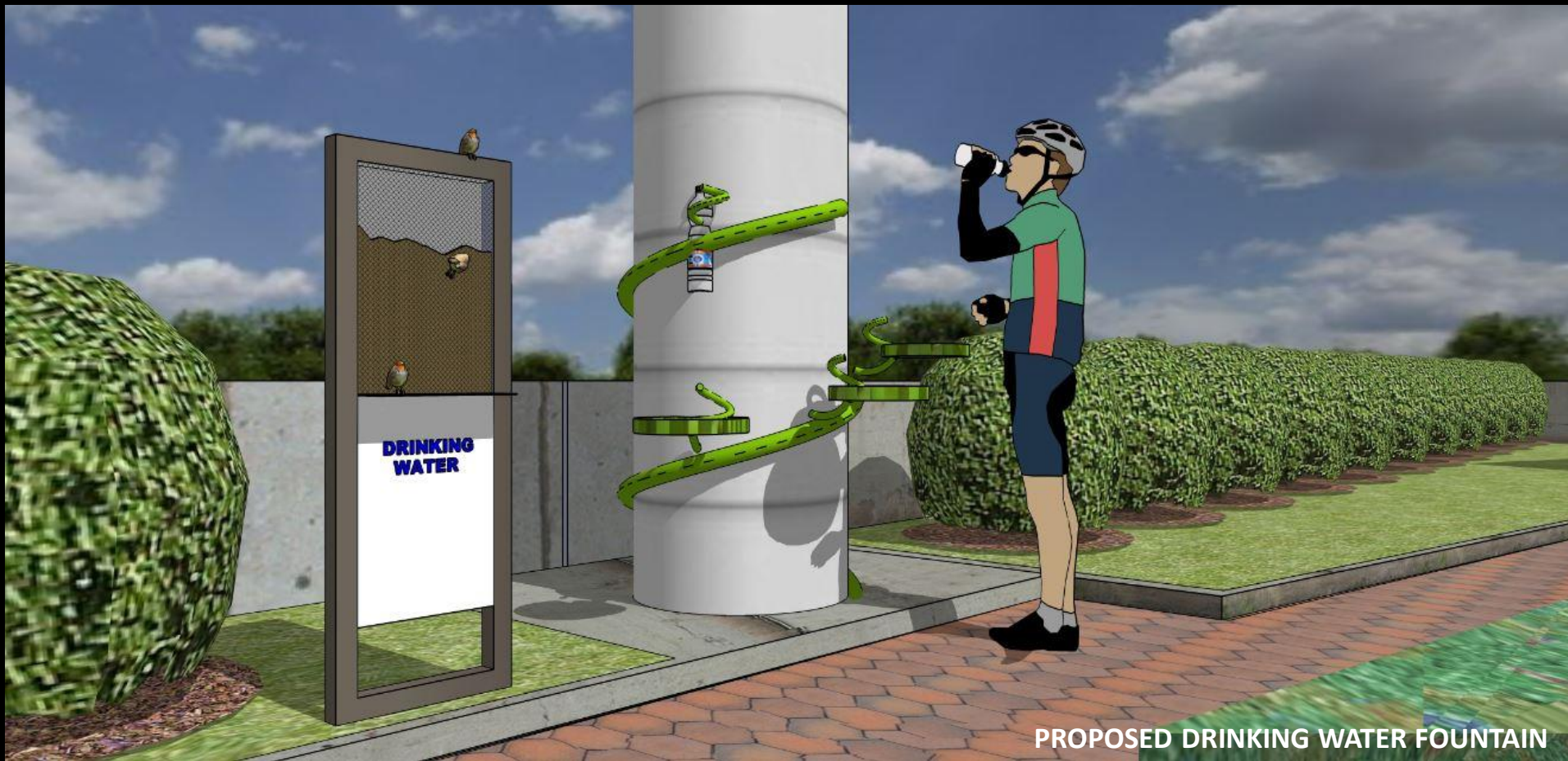

PROPOSED DRINKING WATER FOUNTAIN

EXISTING PLACE FOR DRINKING WATER



PC : VISHAL PAREKH

The existing drinking water fountain is a typical structure of brick & concrete. We are proposing to make it more elemental. The idea is to make a structure which is wrapped with creepers. The cylindrical structure is RCC pipe. With water tank hidden about and creepers is made of bent GI pipes with fabricated leaf bowls.

GRAPHICAL PRESENTATION -05

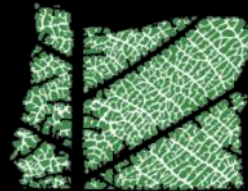



PARK AERIAL VIEW

EXISTING AREA VIEW THROUGH GOOGLE MAP



This is the aerial view of the park. Where you can see zen area, children play area, lawn area and gym area as well as the gorgeous gazebo, seraphic pathway, attractive junction, spectacular entrance and cylindrical drinking water facility.

NOTE: THE TREES SHOWN IN 3D VIEW ARE INDICATIVE TO MAKE DISPLAY A CLEAR VISION HENSE DESIGN DOES NOT INTENT TO CUT LARGE TREES.

GRAPHICAL PRENTATION- 06

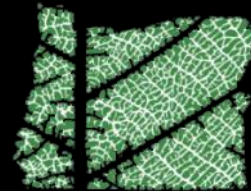



Tree seating

Seating is design around tree which will highlight the tree and it will utilize the area around it for seating.

a waste cement pipe is used to make a structure. The seating around is fabricated with pipes.

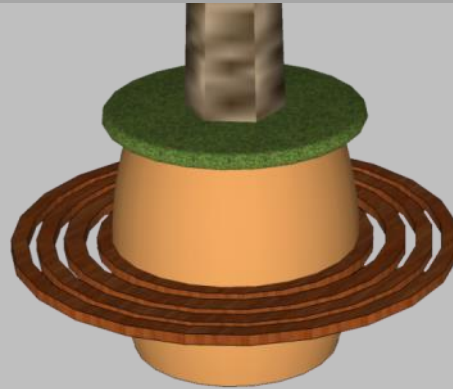

Tree Grating

Grating is done of terra cotta which will blend with the surrounding area's natural material.

Terracotta is one of the earthy material and is recyclable.

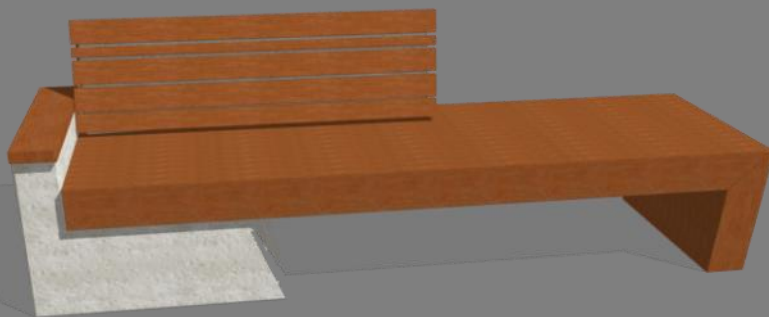
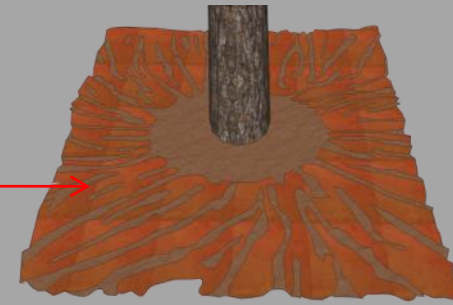

Bench

Benches are proposed to be made with RCC based and recycled fiber planks. The design will create unique combination with landscape.

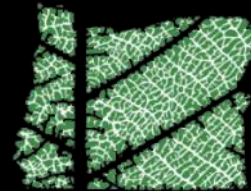

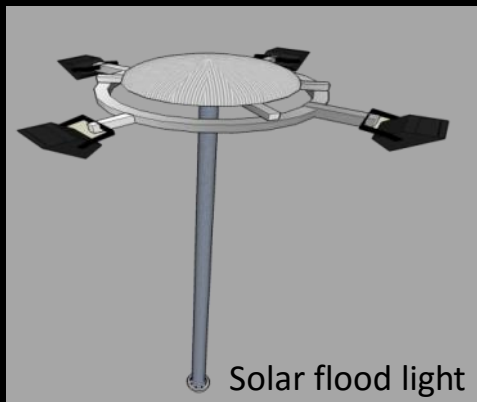

Solar flood light



Bollard light

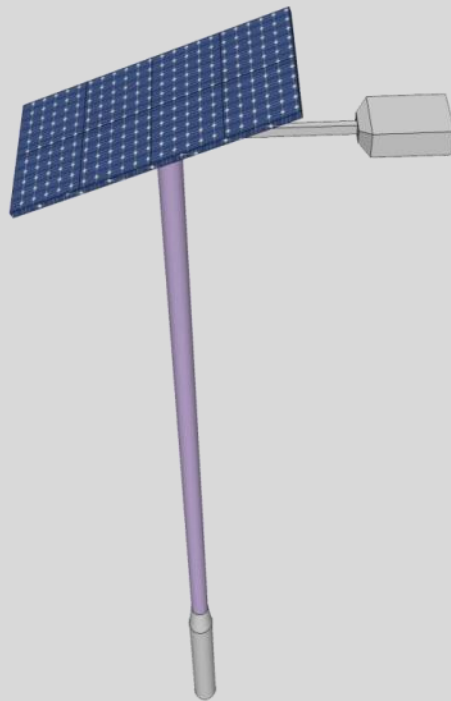

Solar light

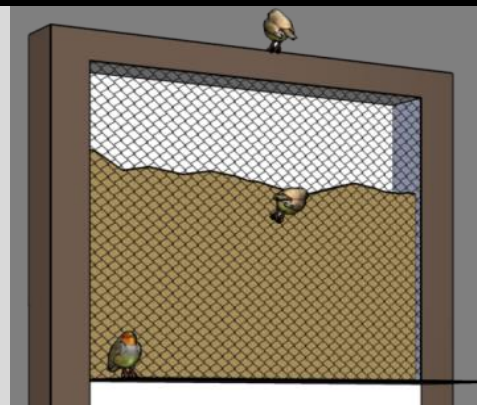

Signage

A simple pipe structure is envisaged not just an information board but also served as bird feeder. A wired mesh used to contain bird food which makes birds to attract and sit for the food.



Lights

Flood lights are highly intensity artificial lights. Generally they are 75-100 lumens/watt.

Bollard lights are upright ground mounted units. It gives light from the top or sides. It uses to illuminate walkways, steps or pathways.

Solar lights consumed photovoltaic panels and these panels charge a rechargeable battery which powers a fluorescent or LED lamp.

As solar lights is used they will save electricity and they are safest way to produce light.



Dustbin

They are anti corrosion, fire proof, easily cleaned up.

They have two types of bin as one is recycler and another one is non-recycler.

The material used for dustbin is also a recyclable.

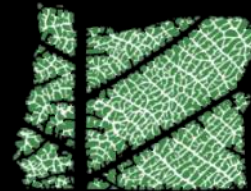

EXISTING VS REPLACEMENT PLANTATION LAYOUT



- THE PLANTATION IS THE KEY FEATURE OF THE WHOLE LANDSCAPE AREA WHICH IS MAIN CONCERN TO MAKE A PARK BEAUTIFUL. ALL BIG TREES ARE RETAINED AS IT IS AND THE PLANTS WHICH CREATES OBSTRUCTIONS ARE SUGGESTED TO REMOVE AND REPLANT .
- WE ARE SUGGESTING ONLY NATIVE PLANTS AS REPLACEMENT PLANTS TO MINIMIZE IRRIGATION REQUIREMENT AND PROLONG TREE LIFE.
- IT CAN BE A THEMED BASED SEASONAL COLOURED PLANT WHICH CAN GIVE US A BEAUTIFUL AND UNIQUE URBAN EXPERIENCE TO THE 'SMART CITY'.

ADDITIONAL FEATUES (PLANTS)-03

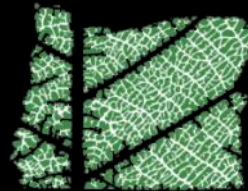



PC.: WWW.URBANLANDSCAPE.COM



SUGGESTED PLANTS

ALTERNANTHERA

'ALTERNANTHERA' GIVES STUNNING COLOURS ALL YEARS AROUND. IT HAS STUNNING GROUND COVER, LOW HEDGE EDGING, CLIPED TO SHAPE OR LEFT TO GROW. THIS WILL DEFINATELY GIVE THE BRIGHT FOCAL POINT IN A PARK.

BAMBOO GRROVE

BAMBOO IS A FAST GROVING PLANT THAT MAKES A GREAT PRIVACY SCREEN AND COMES IN VARIETY OF SPECIES.

GOLDEN DURANTA

'GOLDEN DURANTA' IS A SHRUB WHICH GROW IN EQUEL WIDTH. THE MAIN ASSET IS THAT IT CAN BE SHAPES AIN VARIETIS AND CAN SAVE COST OF PERMENANT FENCING.

BOTTLE PALM

BOTTLE PALM IS REALLY GRACE FULL AND IT IS EXTENSIVELY CULTIVATED IN INDIA.ITS ASSET IS THAT IT CREATES UNIFORMANITY AND IS DEFIANT TO WIND.



PC.: WWW.URBANLANDSCAPE.COM

ADDITIONAL FEATUES (PLANTS)-04

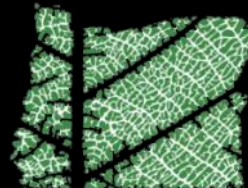



PC.:WWW.PAVERBLOCK.CO.IN



MATERIAL SELECTION

MATERIAL SELECTION IS MADE IN TERMS OF MINIMUM IMPACT ON ENVIRONMENT.

FLY ASH PAVER BRICKS

FLY AS HPAVER BRICKS REQUIRE NO BURNING AND IS A WASTE PRODUCT. WHICH IS MAINLY SUGGESTED FOR PAVED AREA IN A PARK

RECYCLED PLASTIC

RECYCLED PLASTIC CONSTRUCTION OFFERS REPLACEMENT OF TRADITIONAL CONSTRUCTION MATERIAL. IT CAN BE USED AS DIFFERENT PLACES LIKE BENCHES, FLOORING, PANNELLING ETC. IT REPLACES THE WOOD AND IT IS QUICK IN CONSTRUCTION. IT IS ALSO WATER RESISTANE, DURABLE AND UNBRACKABLE.

RUBBER

RUBBER ABSORBS SOUND, NON TOXIC AND FLAM RESISANCE. A RUBBER WASTE CAN BE EXCESSIVELY USED FOR PAVING IN PLAY AREA .



PC.:WWW.LANDSCAPEFORLIFE.ORG



PC.:WWW.USERUBBER.COM

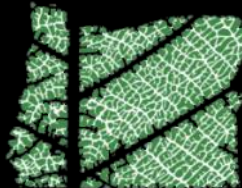

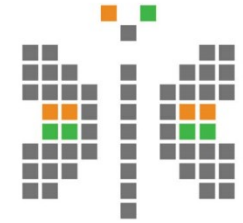

Smart City

MISSION TRANSFORM-NATION

WINNER : 2
PRAKRUTI DESAI

UrbanUs

Team members:

Participant 1:

Name: Ar. Prakruti Desai (B. Arch, M. Arch)

Address: 2/A- 6, D.K. Park Society, Bhatar Road, Near Rupali Canal, Surat-395007

Age: 25

Gender: Female

Profession: Architect, City Designer

Institute/ Firm: Professor- Faculty of Architecture – SCET, Architect at Aangan Architects

Contact no: +91 9726252847

E-Mail address: prakruti.desai6@gmail.com

Participant 2

Name: Ar. Rashi Sonsakia (B. Arch)

Address: 116, Kotyark Ngr, Opp. Navyug College, Rander rd, Surat – 09

Age: 23

Gender: Female

Profession: Architect

Contact no: +8141085577

E-Mail address: rashi17oct@gmail.com

Participant 3

Name: Yash Rajput

Address: 403, Riddhi Siddhi Apt, near Reliance township, Piplod, Surat

Age: 24

Profession: Architecture student

Firm: Vadodara Design Academy, Intern at Aangan architects

Contact no.: 9099893808

E-Mail address: yashrajput76@gmail.com

PARK DESIGN

ISSUES	NEEDS	PROBABLE OUTCOME
Lack of lawns in the park	Lawn areas where people can enjoy sitting in grass as well as it will create an ambience of the park	Providing lawns would encourage more communal activities . It would also attract more bio diversity as well as abate the pollution and avoid storm water run off.
Strong edges blocking the road and park connection	Development of functional and visually accessible edges	By developing porous edges, the park would invite more and more people and can be used more efficiently.
Need for Aesthetical enhancement	Present parks should have interesting aesthetical features which will attract more people in it and would also give an innovation to the mundane designs of parks.	A complete public space which is sustainable as well as artistic would be developed and people would relate more to such spaces.
Lack of artificial lighting	City life in such urban areas is more active during evening and night timings, thus the artificial lighting can be an attraction and change the image of the park.	A dynamic artificial lighting which functions as a source of light as well as act like an artistic light source will enhance the beauty of the park

A STATE-OF-THE-ART PARK

The aim was NOT to design the park with a traditional mindset where landscape and nature are predominant part of the design. Rather we envision the park to be closest of the 'time', being more meaningful amalgamating **NATURE, CULTURE, EXPLORATION, LEISURE and PEOPLE**.

The idea is to evoke an **IDENTITY** not only to the people who visit the park, but also those who just pass-by. The park is a statement of the **contemporary** time and one of its kind.

Being with TIME also means, being, Self- sufficient and Sustainable open space.





The park is located on the junction of the main road and the secondary road.

It is the main focal point to the surrounding neighbourhood societies.

Thus, a neighbourhood park which thrives on its users is envisioned. The main aim of this park is to provide such a public space which is sustainable, cultural as well as artistic



The existing condition of the park is that it is packed by its four edges.

The two edges which are adjacent to the residences are kept intact whereas the other two edges on the road have to be made porous which invites people inside the park.

These edges would be physically confined but visually connected.



The park aims to fulfil the three major criterias which are very essential in present life:

- CULTURE
- NATURE
- FUTURE

The design is a blend of the above three aspects

- **Culture:** It is the first and foremost important thing which has to be kept intact, as a public space serving to its context, it should reflect its own culture and also it is the mirror in which people see themselves day to day.



- **Nature:** An important facet for our existence. Sustainability is the key to a better healthy life. Green lawns, a stroll in the wet grass, a peaceful relaxing seat after a busy day, chirping sparrows and running squirrels in the center of the urban area is the key which every park should achieve in its own.



- **Future:** The park should be culturally enriched as well as it should give the citizens, opportunities to grow themselves for a better futuristic development. A balance of mental as well as physical fitness would lead to futuristic development.



Salient features:

- A loop which combines all the three zones and retrofits the requirements.
- This loop functions in the following ways:
 - **Nature zone:** The existing otlas under the trees are kept intact and a band of extention of seatings runs inbetween them dividing the area into existing earth bed and lawns. Small installations like refurbishing old antique doors and placing them as sculptures and erecting bird feeders (chabutro) would serve to the bio diversity too.
 - **Culture zone:** The compound wall is not disturbed and enhanced by painting graffiti on it, a mini amphitheatre which is very essential for community activities is placed which would be the focal inviting point in the park
 - **Future Zone:** All the instruments are kept intact. The gym instruments are shifted in this zone so the security is maintained and the elders can exercise while keeping an eye on their kids playing. A stone flooring is designed which divides the vast pebbled flooring.



MINI AMPHI

PEBBLES FLOORING

GRAFFITI WALL

STONE FLOORING

LAWN

BIRD FEEDERS

-  PEBBLES
-  STONE FLOORING
-  SOFT LANDSCAPE
-  PAVING (EXISTING)
-  EARTH BED (EXISTING)

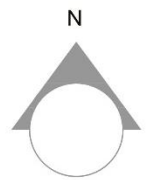



The stone flooring is added to separate the play area and a seating space can be formed in the same. The gym instruments can be shifted to the play zone to maintain the security.



Reference images for stone flooring
Source: Pinterest

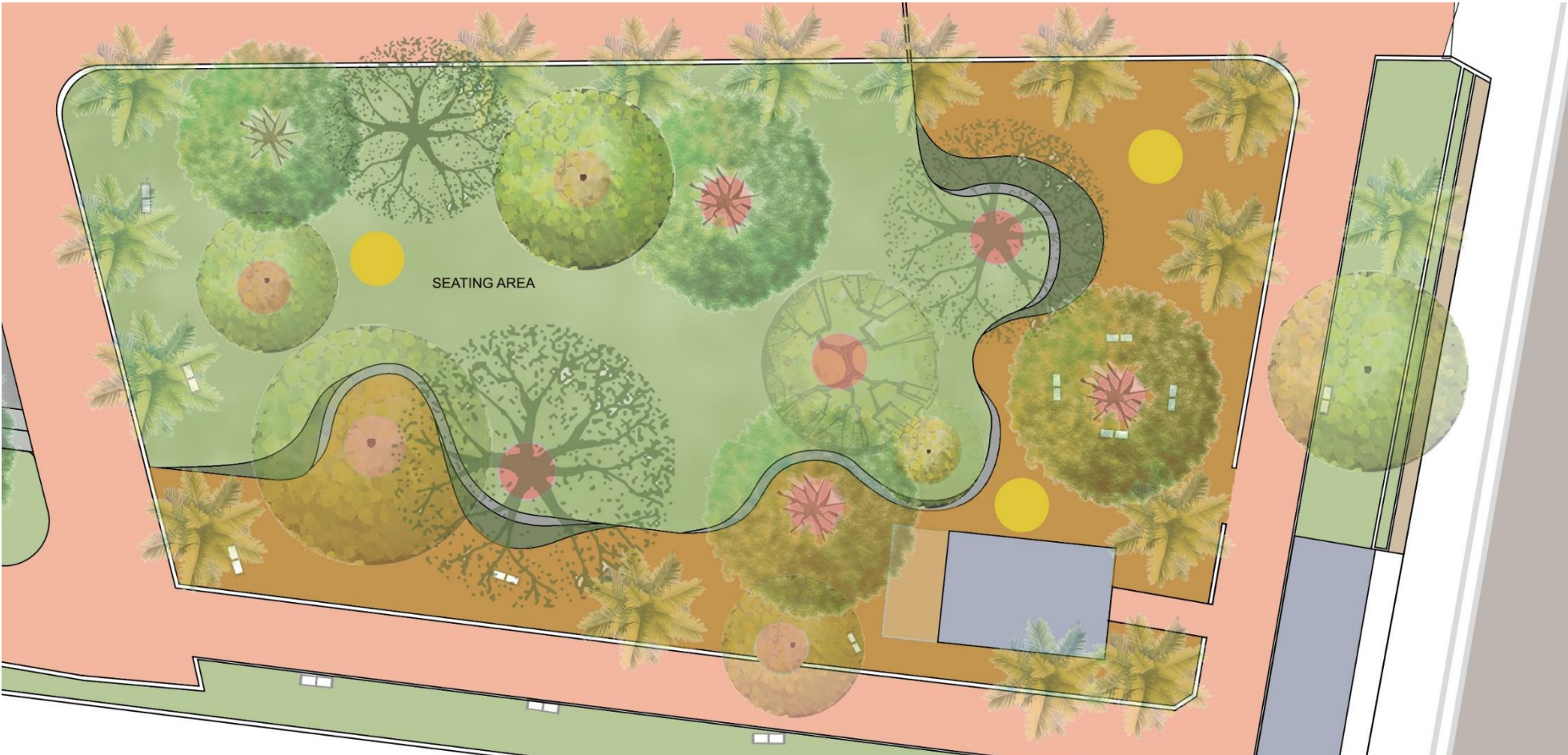

The nature zone is elaborated by a band of seatings flowing around the chotras which would provide more seating space, also bird feeders will be placed in between and installations using scrap doors and windows can be done.



Reference images for artificial lighting, seatings and installations.
Source: Pinterest



Section showing the nature zone.



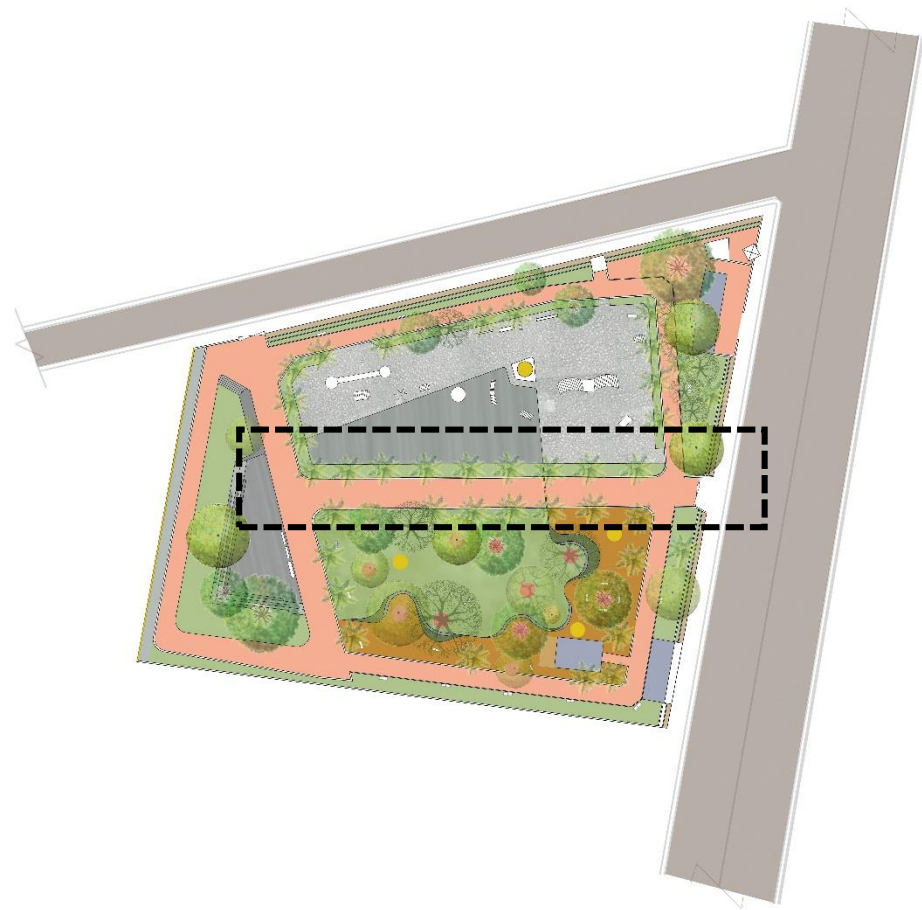

Section through mini amphi



The main spine of the park used as an active space. Events similar to u turn which is only for neighbourhood people can also take place and a colourful space can be developed through public participation.

Elements Of Design:

ELEMENT	WHY ?	FEASIBILITY	REFERENCE
PAVEMENTS	<p>Adding dynamic dimension to pavements making them more experiential and explorative. Features like street games, benches and planters add to the experience of mere strolling in the park. Thus bringing back to the old school street plays into practice.</p>	<p>The intervention can be merely made by good painting choices and skills, thus it is cost effective.</p>	
CHOTTRAS AND CHABUTRAS	<p>The traditional habits and culture of sitting at the chowks and chautras under the trees, we intend to bring back the same by beautifying and modernising those traditional elements. The chabutras will keep the existing bio diversity intact and also invite new birds into the park.</p>	<p>The chautras can be executed by concreting seatings and the chabutras can be made by fabrication. By painting the sculptures from bright colours, it would be aesthetically pleasing and also act as a coat over fabrication.</p>	
FURNITURES	<p>Incorporation of new and low cost street furnitures.</p>	<p>Furnitures can be made by low cost materials as well as waste, for eg. Solar pipes and other industrial pipes can be assembled to form benches. Dead wood trunks can be painted and used to sit.</p>	



Section showing the edge of culture zone adjacent to the residential blocks.



Section showing the two road edges













THANK YOU!

Team *UrbanUs*

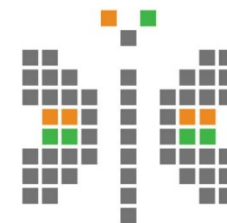

Smart City

MISSION TRANSFORM-NATION

WINNER : 3
MUKUND DALAL

TYPE OF CONTEST: PARK DESIGN

PROPOSED DEVELOPMENT OF VIR BHAGAT SINGH GARDEN @ SURAT

CONTEST # 3 PARK - VISUAL IMPROVEMENT DESIGN CONTEST

Conducted By: Surat Smart City Limited Surat, Gujarat

Applicant Name: Er. Mukund Dalal

Address: B- 508, Tirupati Plaza, Near Multi-storied building,
Athwagate, Surat- 395 001.

Age: 55

Gender: Male

Profession: Practicing as Planner, Structural Designer, Interior Designer
& Valuer since last 30 years.

Contact No.: +91 9374712387



E-mail: dalalmukund@yahoo.co.in







PROPOSED DEVELOPMENT OF VIR BHAGAT SINGH GARDEN @ SURAT

CONTEST # 3 PARK - VISUAL IMPROVEMENT DESIGN CONTEST



Sr. No.	PHOTOGRAPHS	IDENTIFICATION OF ISSUES
1.		<ul style="list-style-type: none"> ➤ Entrance gate is not charming & welcoming. ➤ There is no name of the park on the Beam top. ➤ M.S. Gate to be redesign. ➤ No Bollards to avoid any vehicular traffic movement in the park. ➤ Requires proper rotunda type entrance gate with signage. ➤ There is no Parking provision at existing facility. Must be provided.
2.		<ul style="list-style-type: none"> ➤ Care taker room required maintenance; i.e., Waterproofing @ terrace, replacement of old doors-windows with new one, paint work, etc...

Sr. No.	PHOTOGRAPHS	IDENTIFICATION OF ISSUES
3.		<ul style="list-style-type: none"> ➤ Seating benches are placed very randomly. Requires to re-arrange on the periphery to get large open space (without any obstruction) for many activities. ➤ Old benches are very boring, hence new creatively designed benches are to be placed along with existing ones to break the monotonous visual effect of the garden. ➤ No development of lawn. ➤ New Shrub's plantation is required to create boundary between walkway & lawn area to restrict the entry of the same from many places.
4.		<ul style="list-style-type: none"> ➤ Bund wall around the big trees can be used as seating element, if they repair and finish properly. Which leads to more seating area. ➤ Drain chambers cover should be replace with new one and relocate @ some places if requires. ➤ Many Benches are not in good condition to seat. Requires to replace with new one.

Sr. No.	PHOTOGRAPHS	IDENTIFICATION OF ISSUES
5.		<ul style="list-style-type: none"> ➤ Unique tree requires more focus, so people can have look at it. Right now around the unique tree there are many small plants around it which are acting as obstruction. ➤ Requires to relocate these small plants to some other places, so we can get some more cleaned space around this unique tree. ➤ New spot light can be place around this tree. ➤ We can create SELFIE POINT at this location with unique tree in backdrop.
6.		<ul style="list-style-type: none"> ➤ Drinking water structure requires beautification to increase the use of it. ➤ Cold drinking water facility can be provided. ➤ Drinking water fountain can be placed instead such a large drinking water structure.

Sr. No.	PHOTOGRAPHS	IDENTIFICATION OF ISSUES
7.		<ul style="list-style-type: none"> ➤ Old dustbins to be replaced with THREE CONTAINERS dustbin system (Wet garbage, Recyclable garbage waste & plastic waste) for better garbage maintenance system. ➤ Very few light poles around walkways. Solar light poles can be placed at various location wherever it is required.
8.		<ul style="list-style-type: none"> ➤ Many new playing equipments (other than conventional equipments) should be place to increase the use of the play area. ➤ 'Chabutro' (Bird feeding point) should be provided in the park.
9.		<ul style="list-style-type: none"> ➤ Park internal new way-finding signages area required for ease movement of visitors. ➤ New seating benches should be provided at periphery of the open area in shaded walkway.

02.Salient Features Of The Proposed Solution

Sr. No.	PHOTOGRAPHS OF EXISTING SITE CONDITION	PRPOSED DESIGN SOLLUTIONS	SALIENT FEATURES
1.			<ul style="list-style-type: none"> ➤ Improper and unattractive old entrance is replaced with new well designed attractive entrance which also resembles the name of garden paying tribute to Vir Bhagatsingh with story of his struggle for freedom in brief.
2.			<ul style="list-style-type: none"> ➤ Scattered benches without any proper planning are replaced with new benches having a diamond shape reflecting nature of diamond business of surrounding residential people. Old benches can be reused in surrounding streets /outside garden or in other underdeveloped area.
3.			<ul style="list-style-type: none"> ➤ Also group sitting is provided for proper interaction.
4.			<ul style="list-style-type: none"> ➤ Existing walkways are kept intact but solar panels are added on top for shading as well as for sustainability. Garden lights surrounding the walkway can be illuminated through solar energy.



02.Salient Features Of The Proposed Solution

Sr. No.	PHOTOGRAPHS OF EXISTING SITE CONDITION	PROPOSED DESIGN SOLUTIONS	SALIENT FEATURES
1.			<ul style="list-style-type: none"> ➤ Instead of old single container dustbins, Aesthetical dustbins segregating paper, plastic and wet waste are provided so that the waste can get recycled.
2.			<ul style="list-style-type: none"> ➤ Instead of old dustbins, Aesthetical dustbins segregating paper, plastic and wet waste are provided so that the waste can get recycled.
3.			<ul style="list-style-type: none"> ➤ New way finding attractive sign ages are introduced for proper identification of various spaces and facilities.
4.			<ul style="list-style-type: none"> ➤ Children playing equipments has been reorganised to enhance functionality and some new equipments are added to enhance attraction.

PROPOSED DEVELOPMENT OF VIR BHAGAT SINGH GARDEN @ SURAT

CONTEST # 3 PARK - VISUAL IMPROVEMENT DESIGN CONTEST

GARDEN LAYOUT



CONCEPT NOTE:

- Keeping location of **walkways** intact shrubs/plantations are provided in such a way so as to **channelize pedestrian movement** which will enhance garden lawn development (which at present is not well developed). This channelization of movement will also avoid unorganized access to play & open seating area.
- Compound wall is kept intact but **new attractive colour** is proposed with social interactive slogans such as **Swaccha Bharat Abhiyan, Quotes** and mainly **Patriotic (Desbhakti) Slogans** reflecting the name of garden. **Advertisements space** are proposed on cement bonded particle board & acrylic to be affixed on grills over compound wall.
- At present **Birds feeding point** is in play area which is replaced behind amphitheatre and a **'Chabutaro'** is placed behind amphitheatre.
- Original rain water recharge point for rainwater is kept intact but an additional one is proposed near drinking water structure considering the area of garden.
- Only retrofitting of drinking water facility is to be done without demolition of old facility.
- Only retrofitting of toilet is suggested to enhance functionality and aesthetic appearance.
- Diamond shape open pavilion is proposed in play area at central junction which is provided with sitting facility so that parents/guardians can have a look at their children easily.
- **Most of old construction** such as **compound wall, walkways, play area, caretaker room, drinking water facility, toilets, etc.** are only retrofitted and not dismantled.







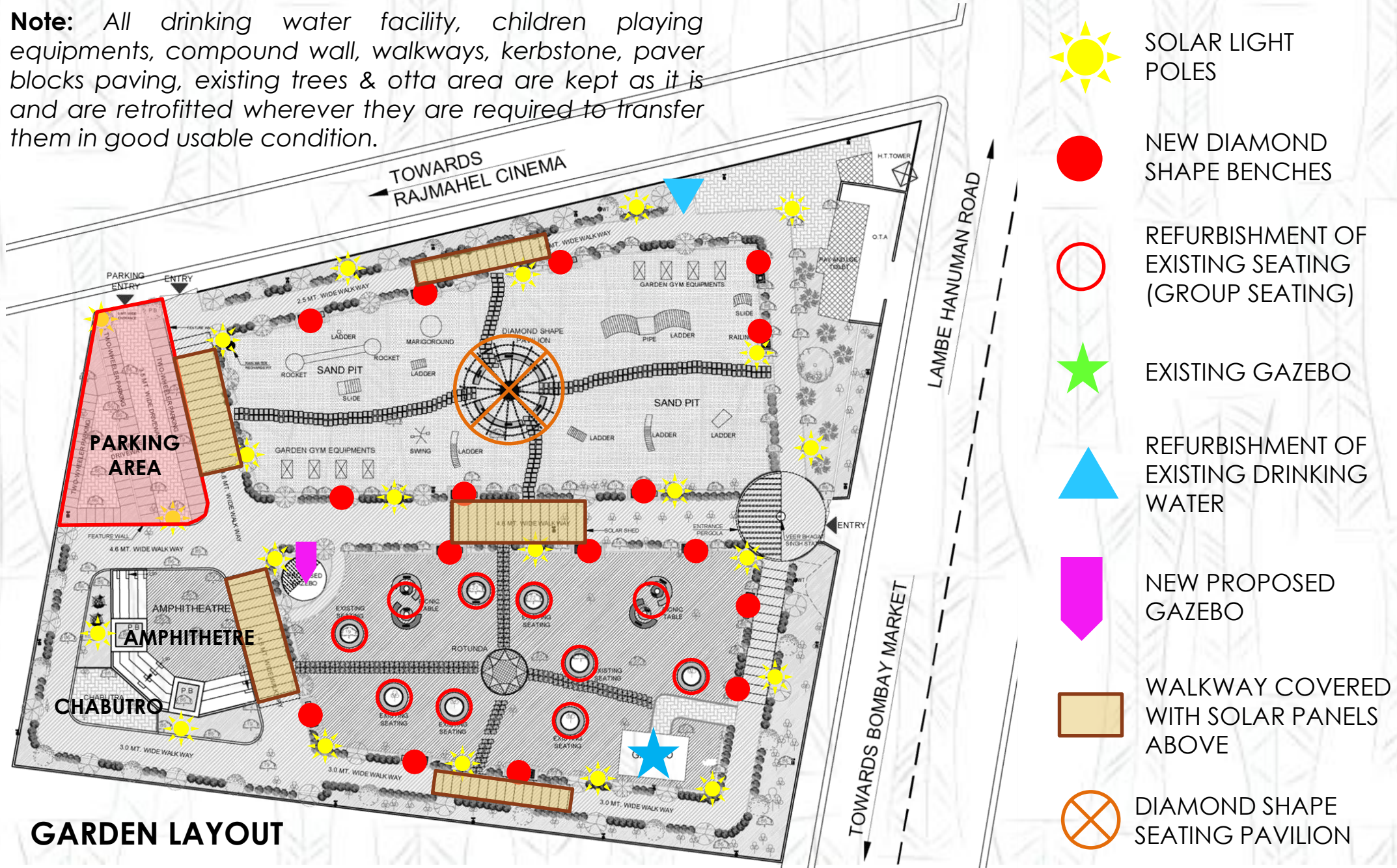

PROPOSED DEVELOPMENT OF VIR BHAGAT SINGH GARDEN @ SURAT

CONTEST # 3 PARK - VISUAL IMPROVEMENT DESIGN CONTEST



Note: All drinking water facility, children playing equipments, compound wall, walkways, kerbstone, paver blocks paving, existing trees & otta area are kept as it is and are retrofitted wherever they are required to transfer them in good usable condition.

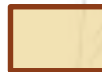

-  SOLAR LIGHT POLES
-  NEW DIAMOND SHAPE BENCHES
-  REFURBISHMENT OF EXISTING SEATING (GROUP SEATING)
-  EXISTING GAZEBO
-  REFURBISHMENT OF EXISTING DRINKING WATER
-  NEW PROPOSED GAZEBO
-  WALKWAY COVERED WITH SOLAR PANELS ABOVE
-  DIAMOND SHAPE SEATING PAVILION

PROPOSED DEVELOPMENT OF VIR BHAGAT SINGH GARDEN @ SURAT

CONTEST # 3 PARK - VISUAL IMPROVEMENT DESIGN CONTEST



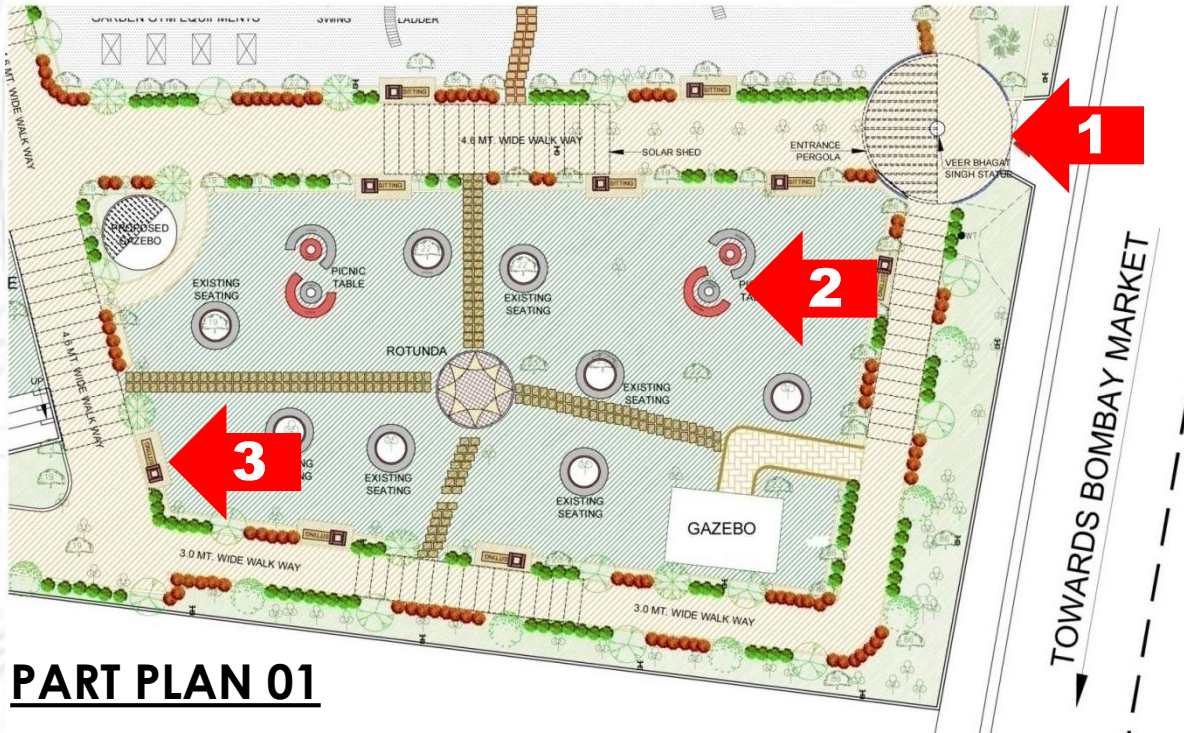

PART PLAN 01



Iconic entrance pavilion with gate & a statue of Vir Bhagat Singh



1. New benches are provided in such a way so that they are accessible from walkways and not from garden lawns so as to protect lawns. Also sitting is possible on benches from both the sides.



2. Group seating is created by retrofit the existing otta development around many trees.

PROPOSED DEVELOPMENT OF VIR BHAGAT SINGH GARDEN @ SURAT

CONTEST # 3 PARK - VISUAL IMPROVEMENT DESIGN CONTEST





SOLAR WALKWAYS & POLE LIGHTS

- Crowning the covered walkways, the dual purpose; provides shade for the public along with generating electricity feeding into the grid.
- Solar street lighting adopted for streets and plazas. Reduce the costs of trenching and installing underground wires & to minimize dependency on non-renewable resources.

Diamond shape benches on the periphery to create more open space in central open space.



PART PLAN 03

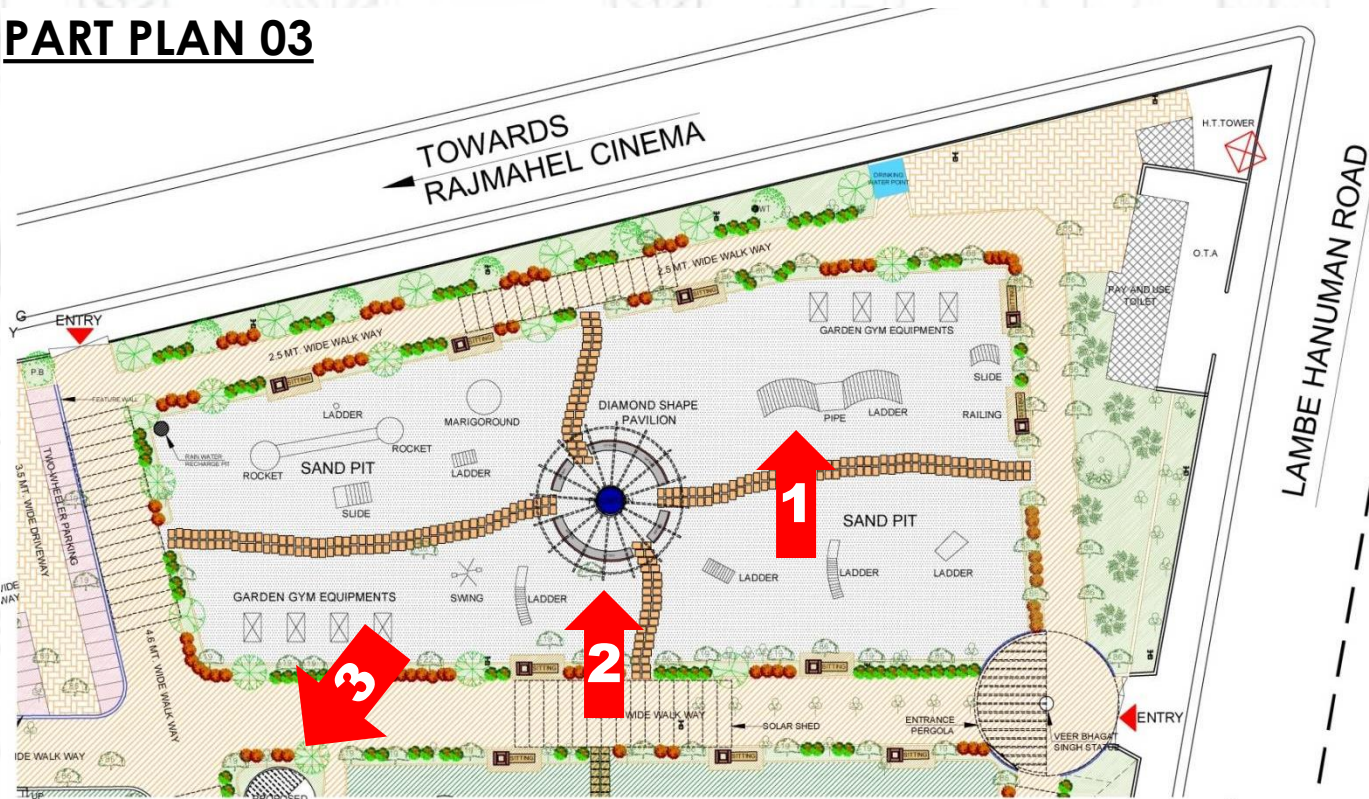

Modern playing equipments to create interest in children and as well as in adults.

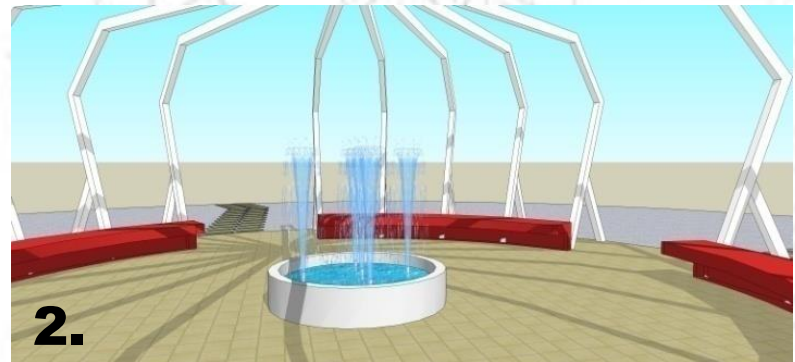

New circular shaped gazebo is proposed with creepers growing over this gazebo.



New circular shaped gazebo is proposed with creepers growing over this gazebo.



New well designed attractive entrance having statue of Vir Bhagat Singh with story of his struggle for freedom in brief.



SOLAR WALKWAYS & POLE LIGHTS

- Crowning the covered walkways, the dual purpose; provides shade for the public along with generating electricity feeding into the grid.
- Solar street lighting adopted for streets and plazas. Reduce the costs of trenching and installing underground wires & to minimize dependency on non-renewable resources.



PROPOSED DEVELOPMENT OF VIR BHAGAT SINGH GARDEN @ SURAT

CONTEST # 3 PARK - VISUAL IMPROVEMENT DESIGN CONTEST



Old vehicular tyres are reused as seating element for sustainable development

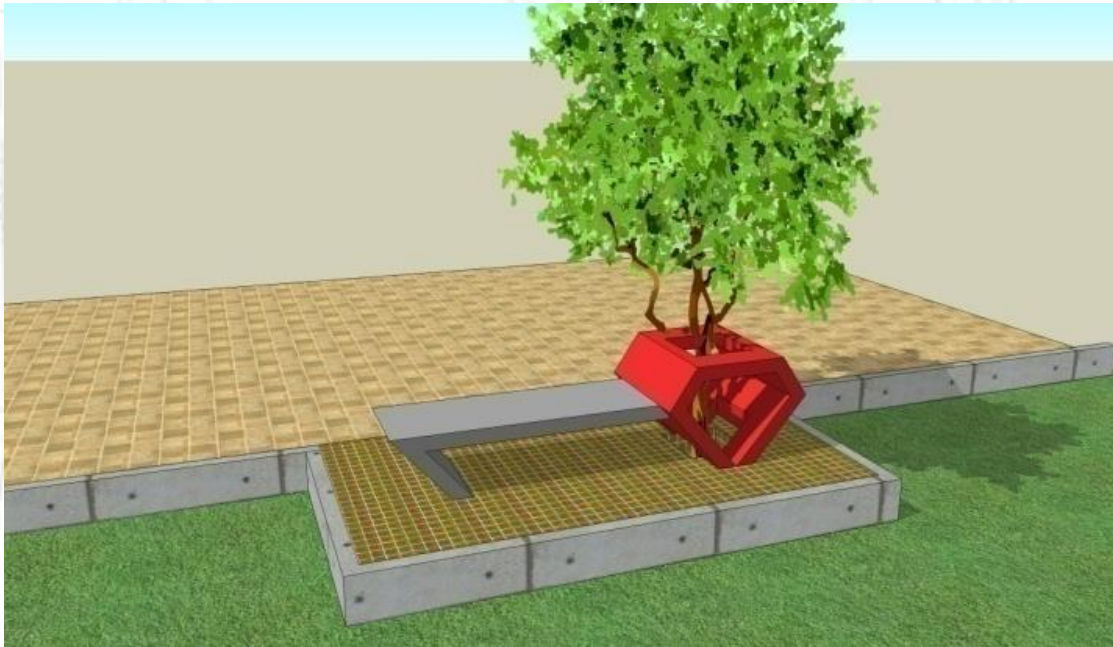

New Benches Having A Diamond Shape Reflecting Nature Of Diamond Business Of Surrounding Residential People.



ENTRANCE GATE:

New well designed attractive entrance having statue of Vir Bhagat Singh with story of his struggle for freedom in brief.



SOLAR WALKWAYS

PROPOSED DEVELOPMENT OF VIR BHAGAT SINGH GARDEN @ SURAT

CONTEST # 3 PARK - VISUAL IMPROVEMENT DESIGN CONTEST





Modern designed tree guard are proposed wherever it is required @ site.



Amphitheatre is proposed around existing trees for social gathering & to watch any live performance.



Diamond shape open pavilion is proposed in play area at central junction which is provided with sitting facility so that parents/guardians can have a look at their children easily.

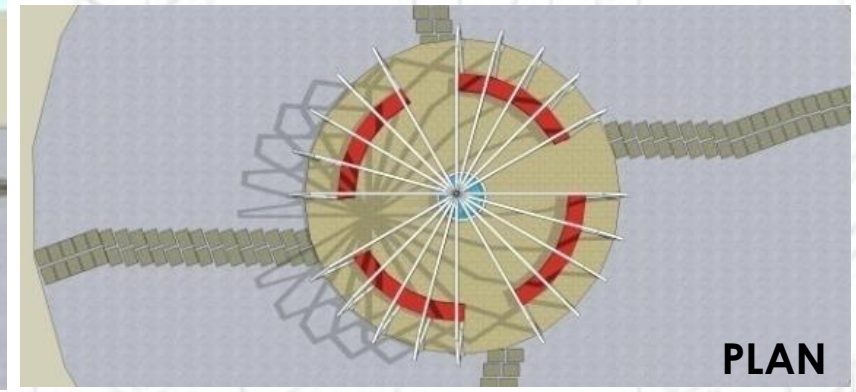
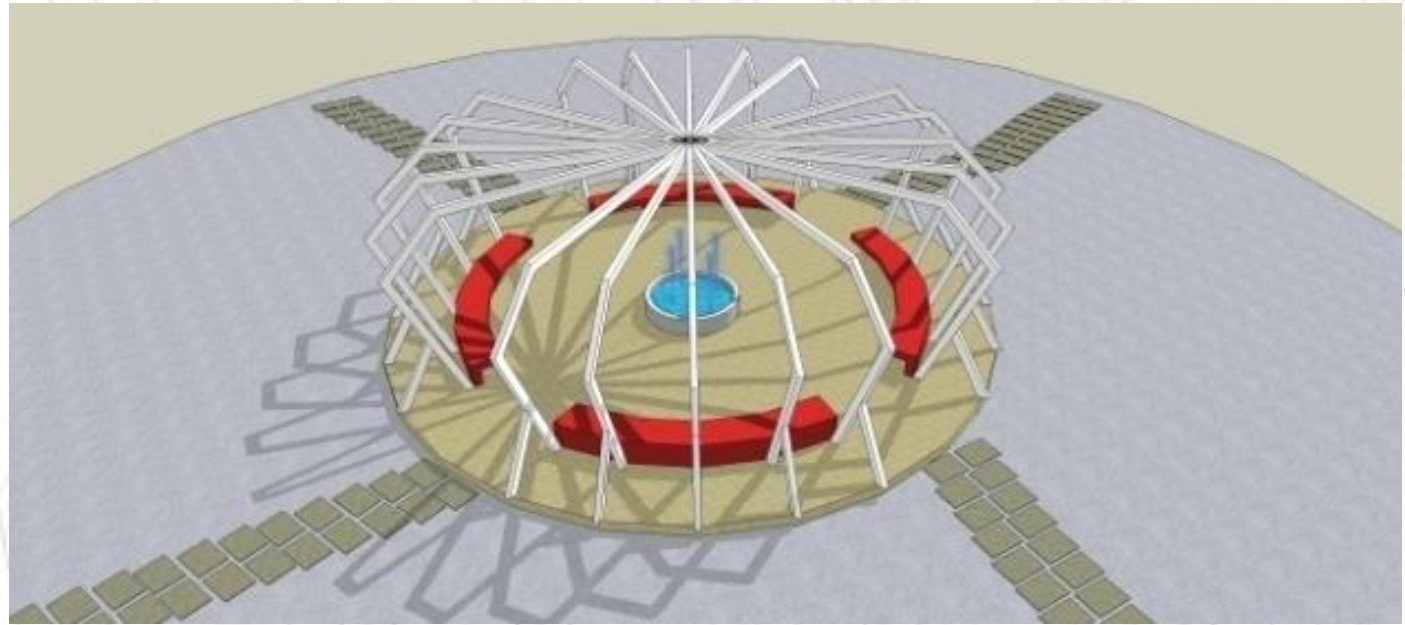

RETROFITTING OF EXISTING TOILET BLOCK



Proposed retro fitting of existing toilet block. Modern and non- maintainable material are used in exterior façade.

PROPOSED DEVELOPMENT OF VIR BHAGAT SINGH GARDEN @ SURAT

CONTEST # 3 PARK - VISUAL IMPROVEMENT DESIGN CONTEST

RETROFITTING OF EXISTING TOILET BLOCK

Proposed retro fitting of existing toilet block. Modern and non- maintainable material are used in exterior façade.

SUSTAINABLE APPROACH:**a. RAIN WATER HARVESTING:**

- Rain water harvesting is the technique of collection and storage of rainwater at surface or in sub-surface aquifers, before it is lost as surface run-off. The augmented resource can be harvested in the time of need. Artificial recharge to ground water is a process by which the ground water reservoir is augmented at rate exceeding that under natural conditions of replenishment.
- We had proposed two numbers of rainwater harvesting system by having percolation pits connected to box drains of suitable size based on runoff quantity and to percolate the requisite water.

b. LAND SCAPE:

- The source of water distribution for irrigation is from the existing toilet block (within the garden premises) Sewage Treatment Plant recycled water collection tank.
- Drip irrigation native and low water consuming plants are adopted for efficient water management strategies.

c. GENERAL POINTS:

- Upward night lighting is reduce by using lighting that focuses on pedestrian paths & road, but at the same time addresses safety & security on the site and maintains a dark night sky.

